

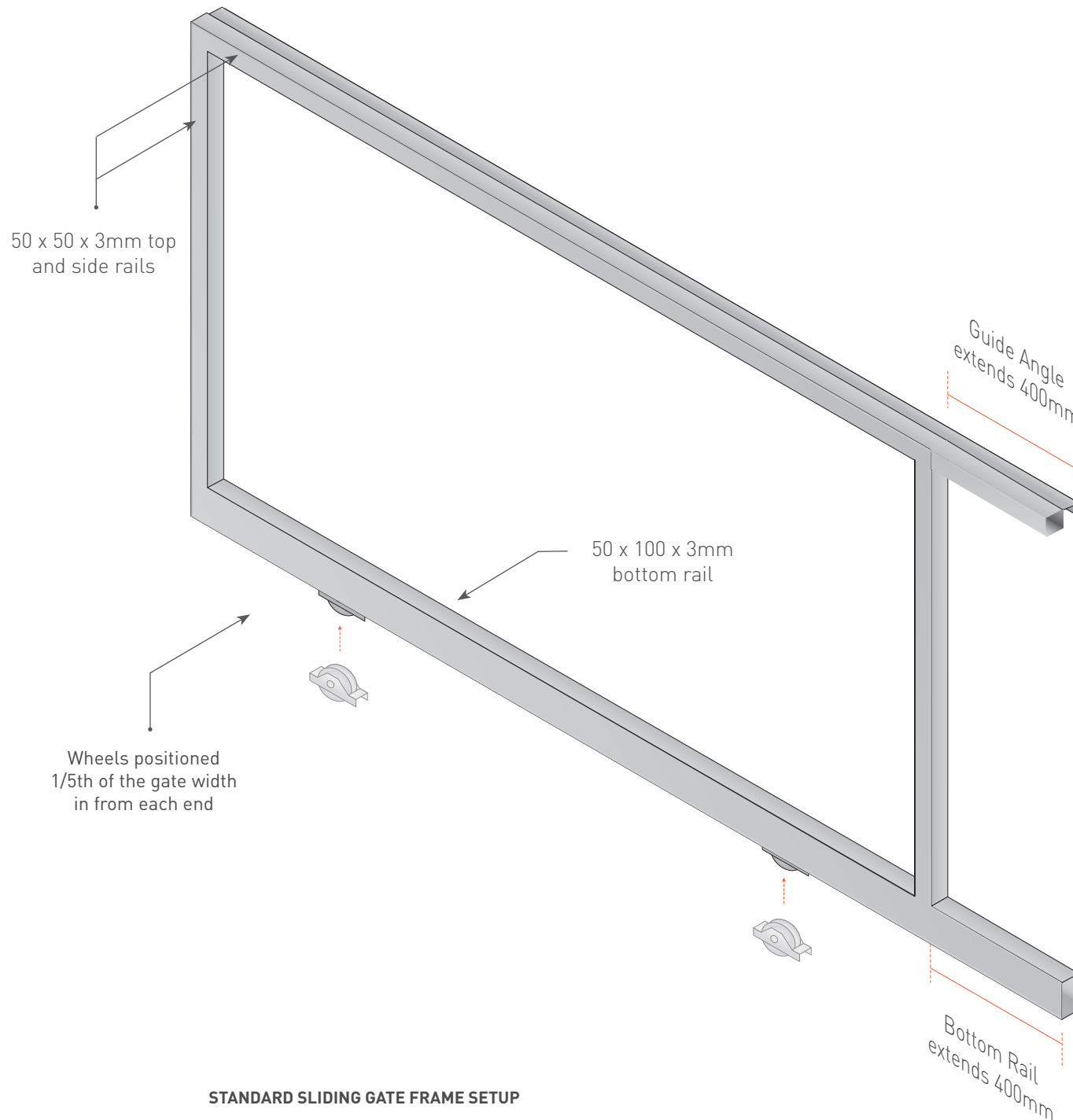

SPECIFICATION SHEETS

SLIDING GATE SYSTEMS



STANDARD SLIDING GATE FRAME SETUP

50 X 50MM SLIDING GATE ALUMINIUM FRAME

50 x 50 x 2mm Sides and Top Rails

50 x 100 x 3mm Bottom Rail

- Bottom Frame used to house Sliding Gate Wheels
- NB: Gates > 5000mm wide 50 x 50 x 3mm Side & Top Rails

SLIDING GATE FRAME DETAILS

Guide Angle Rail runs horizontally along top rail

Guide Angle Rail extends 400mm past Gate End

- This is used in conjunction with the Nylon Block Gate Guide to guide the sliding Gate along the gate track when opening and closing
- NB: If Sliding Gate style has a Double Top Rail, Guide Angle is welded onto the second top rail.

50 x 100 x 3mm Bottom Rail extends 400mm past the Gate End

- This is used for Gate Motor Automation purposes and comes standard whether gate is being automated or not

WHEELS

Wheel Hole Cutouts are positioned approximately 1/5th of the gate width in from each end (20%)

MATERIALS

6063 T6 Aluminium - Powder Coated

All of our Sliding Gates are available in the Interpon Powder Coating Colour Range

TITLE: **SLIDING GATE FRAME DETAILS**

CONTACT sales@qutomax.com



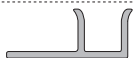
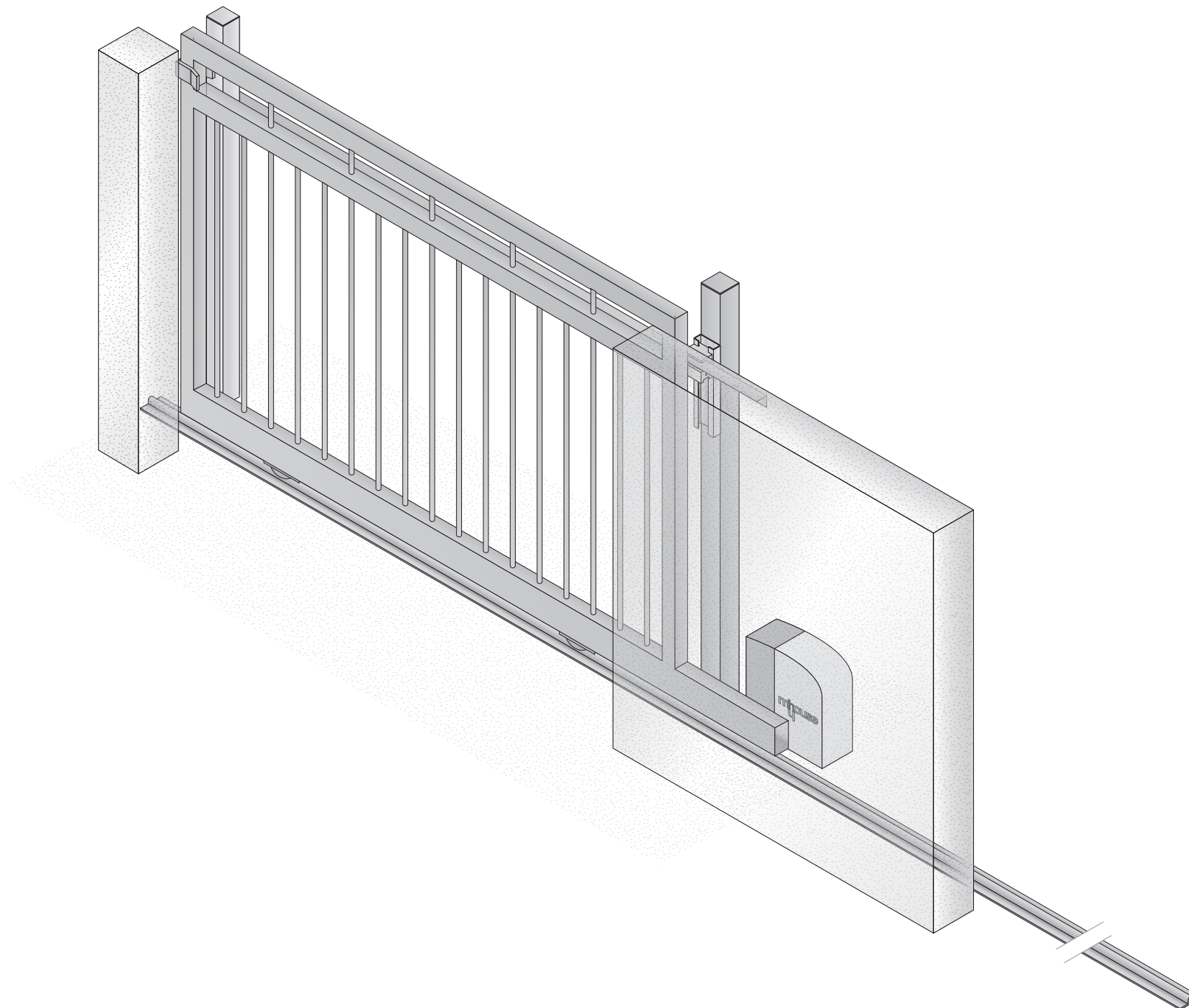

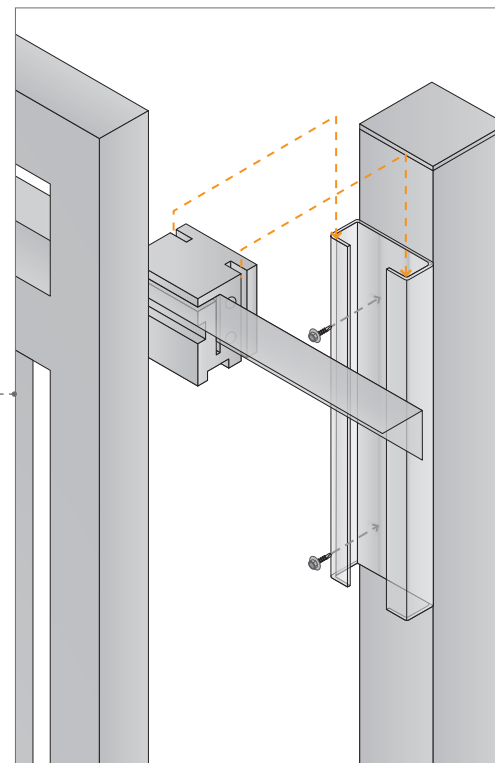
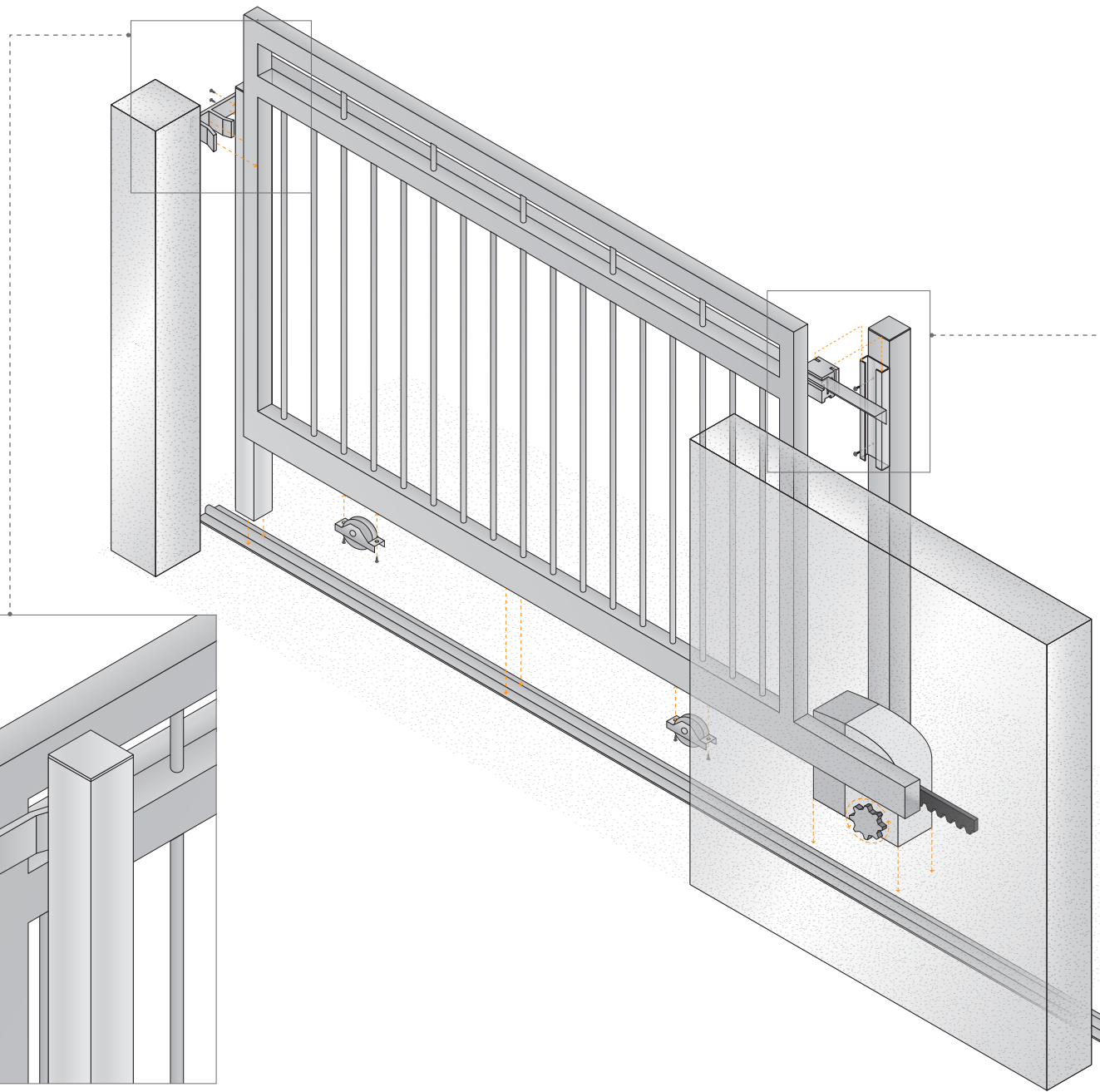

SLIDING GATE GUIDE POST DETAIL

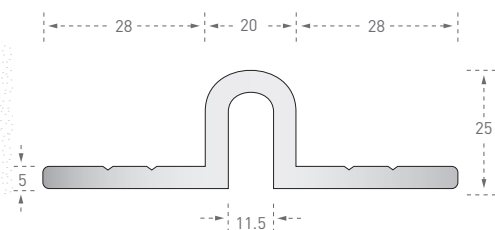

SLIDING GATE TRACK

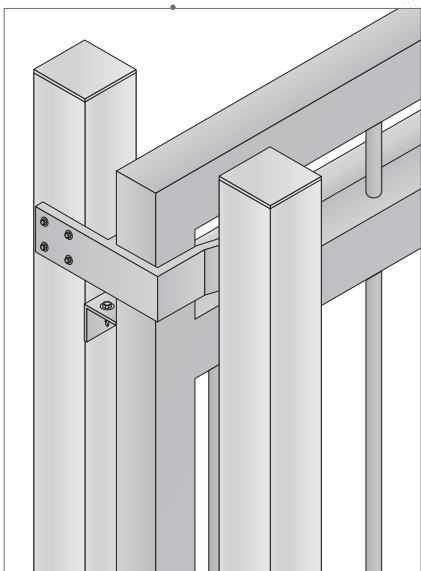

STANDARD F STOP ALTERNATIVE POV

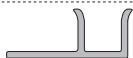

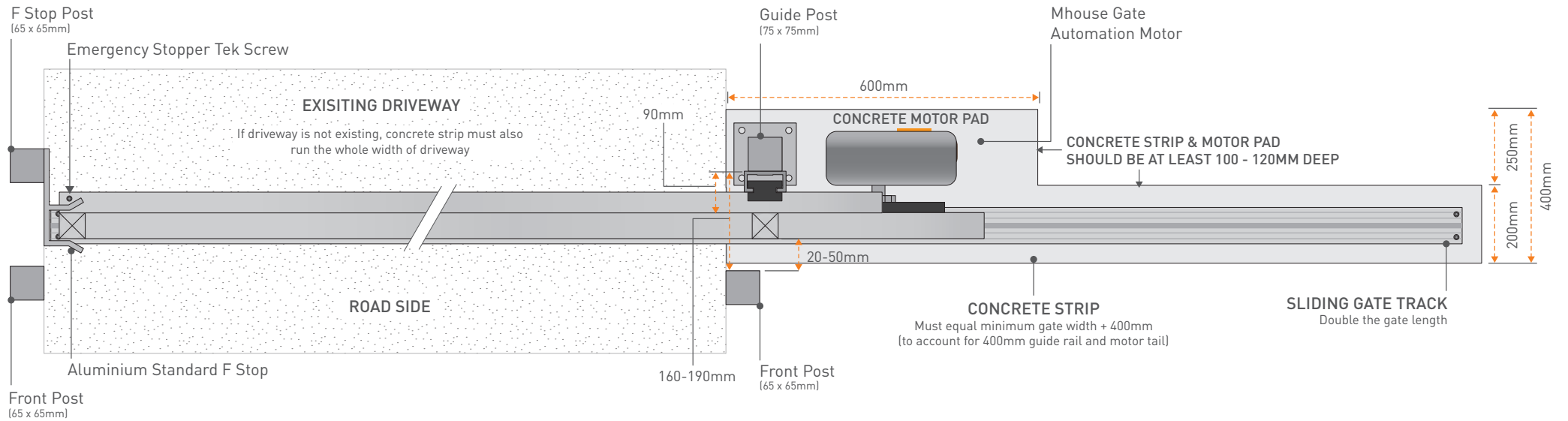

SLIDING GATE SETUP - TOP VIEW

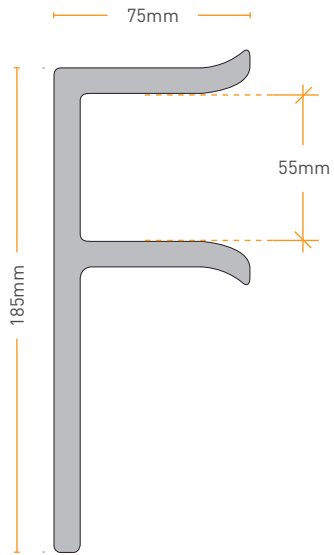

STANDARD F STOP

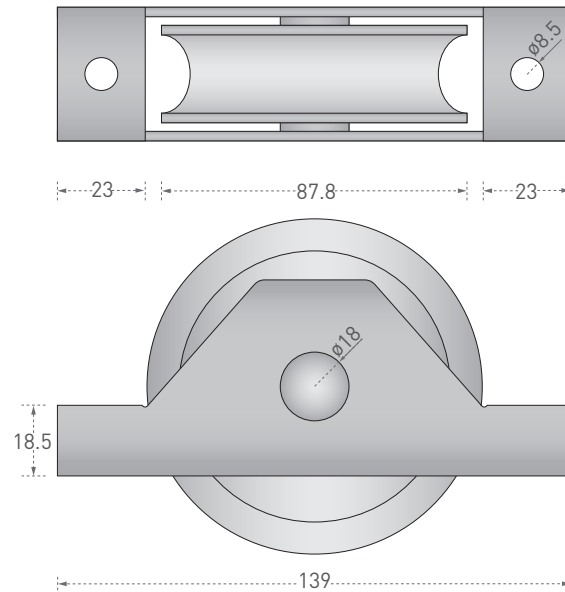

SLIDING GATE WHEEL

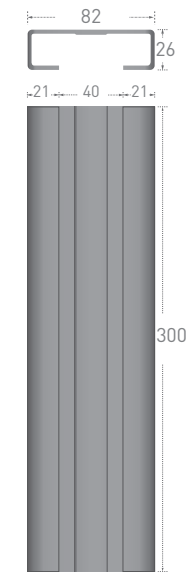

GUIDE CHANNEL

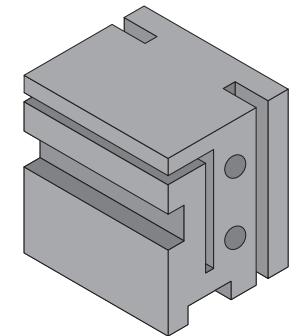

GUIDE CHANNEL BLOCK



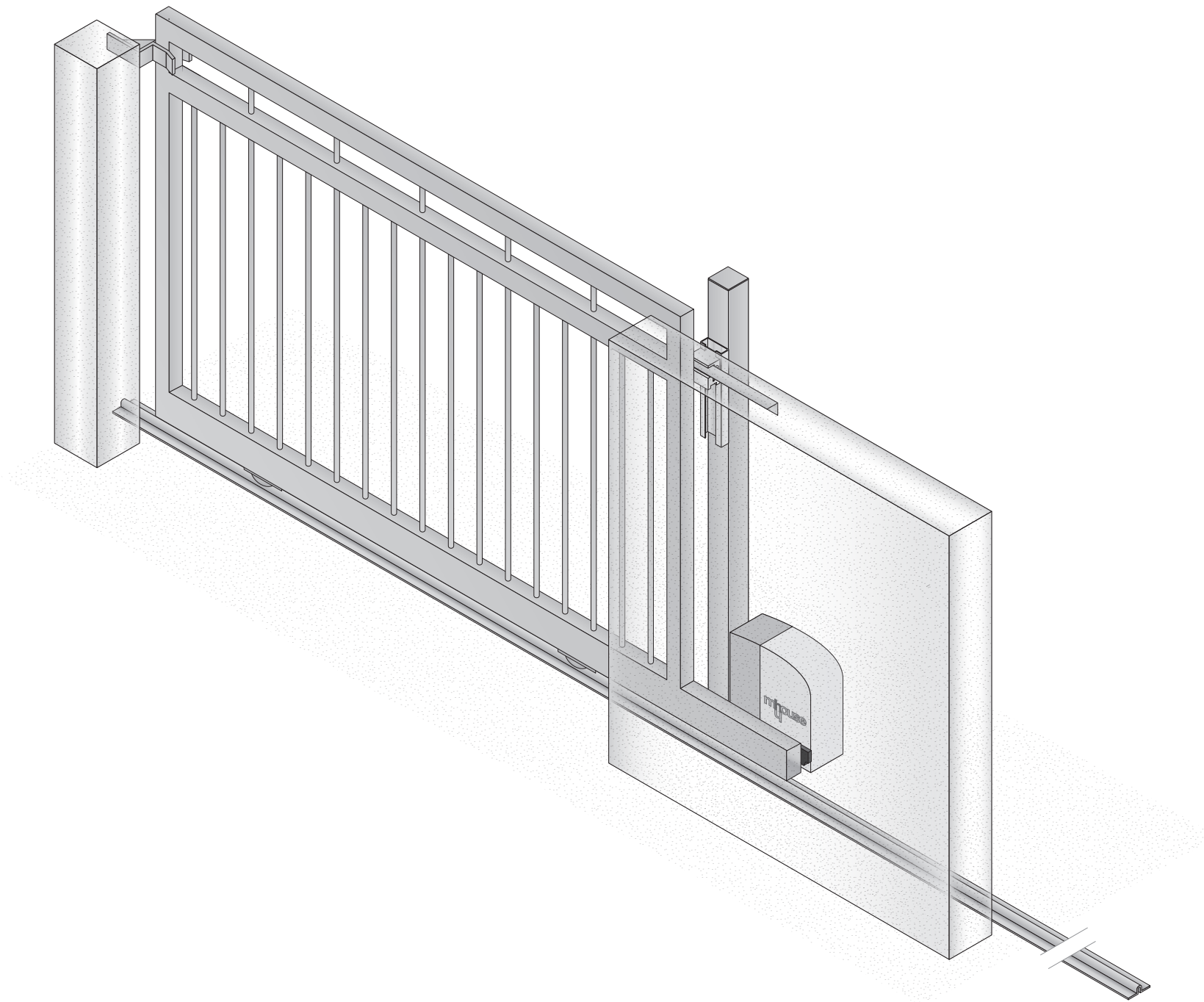

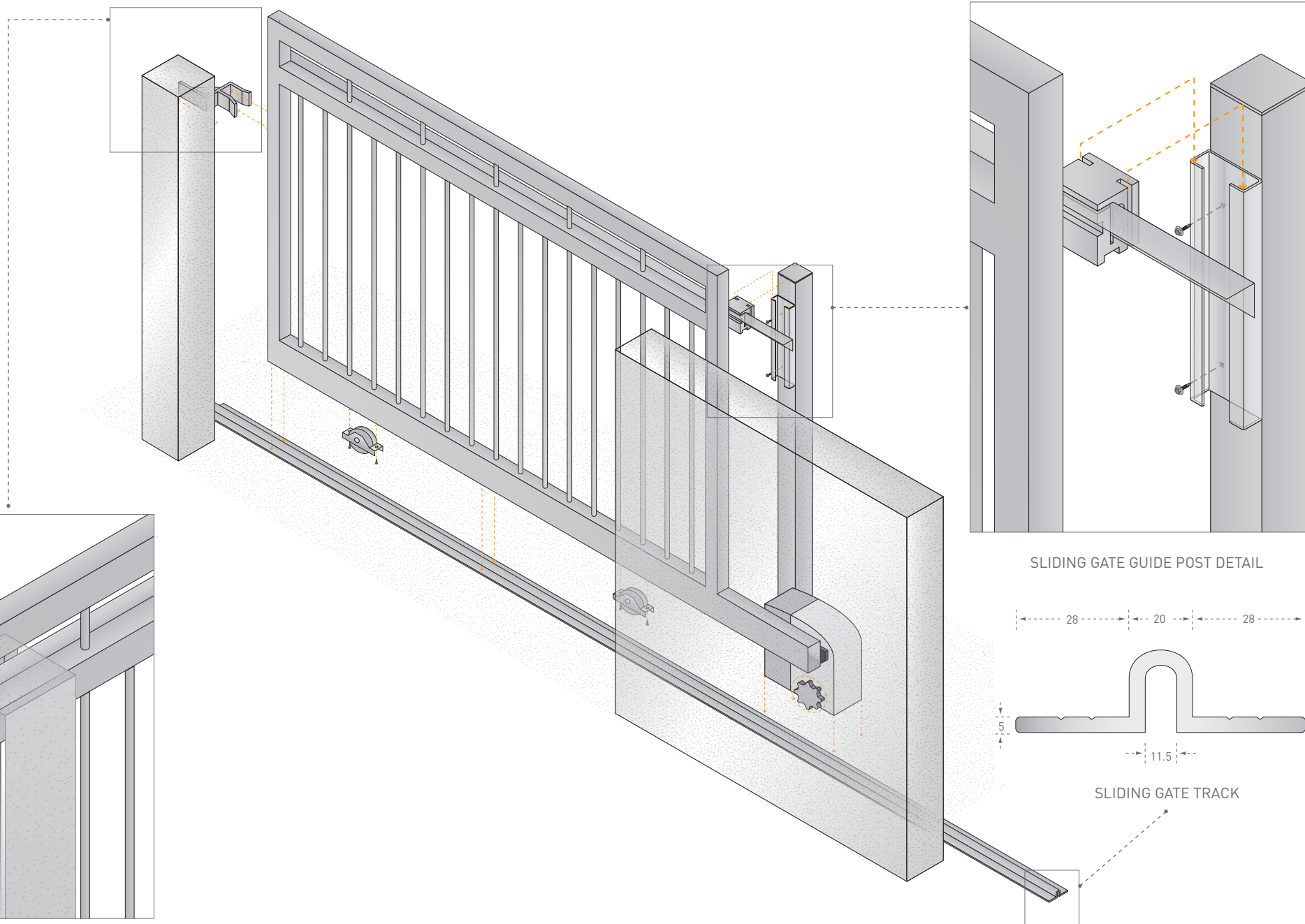

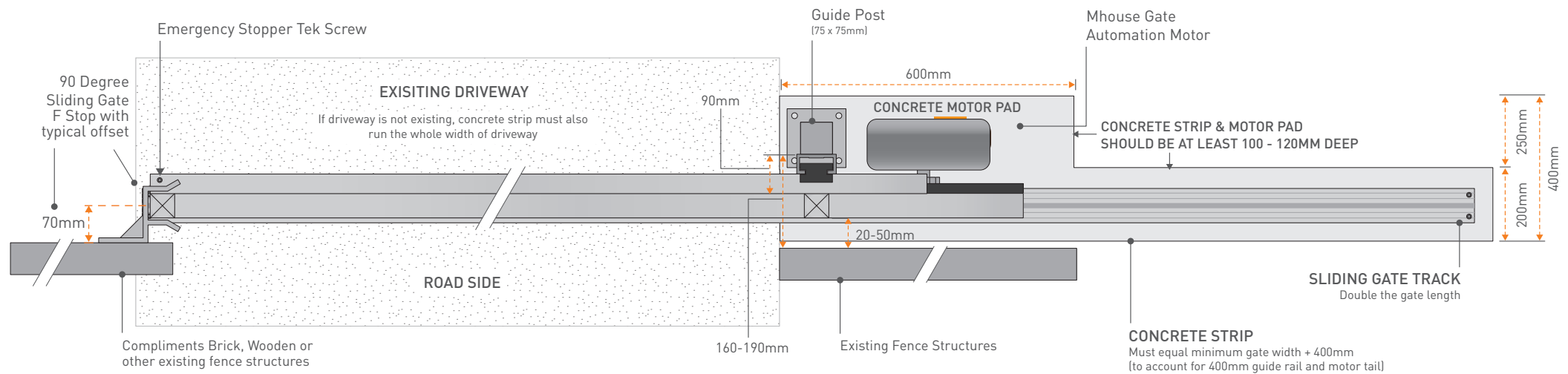

SLIDING GATE SETUP - TOP VIEW

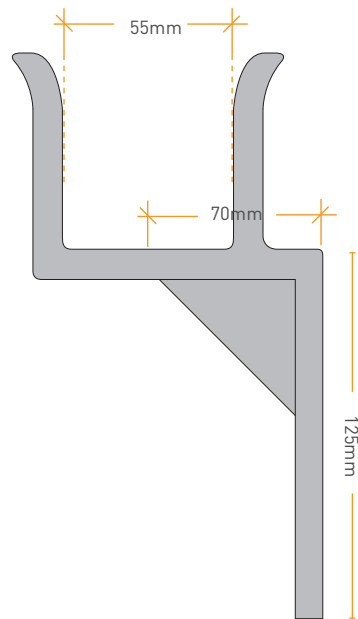

CUSTOM F STOP

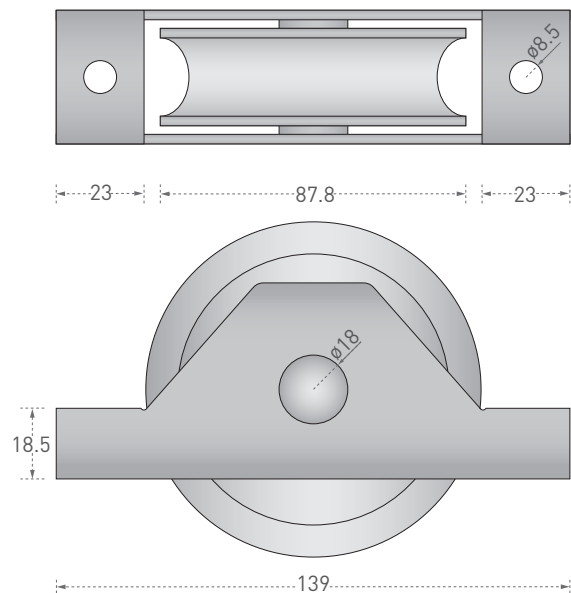

SLIDING GATE WHEEL

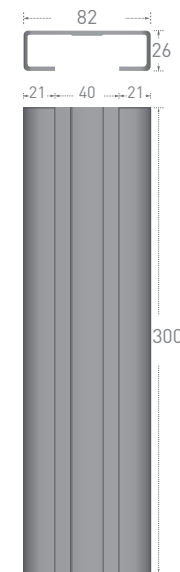

GUIDE CHANNEL

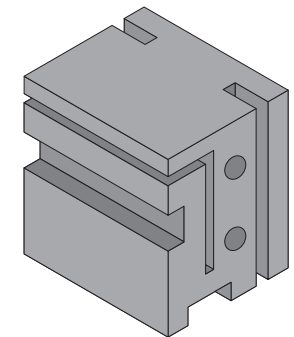

GUIDE CHANNEL BLOCK



SPECIFICATION SHEETS

LASER SCREENS SLIDING GATE SETUP

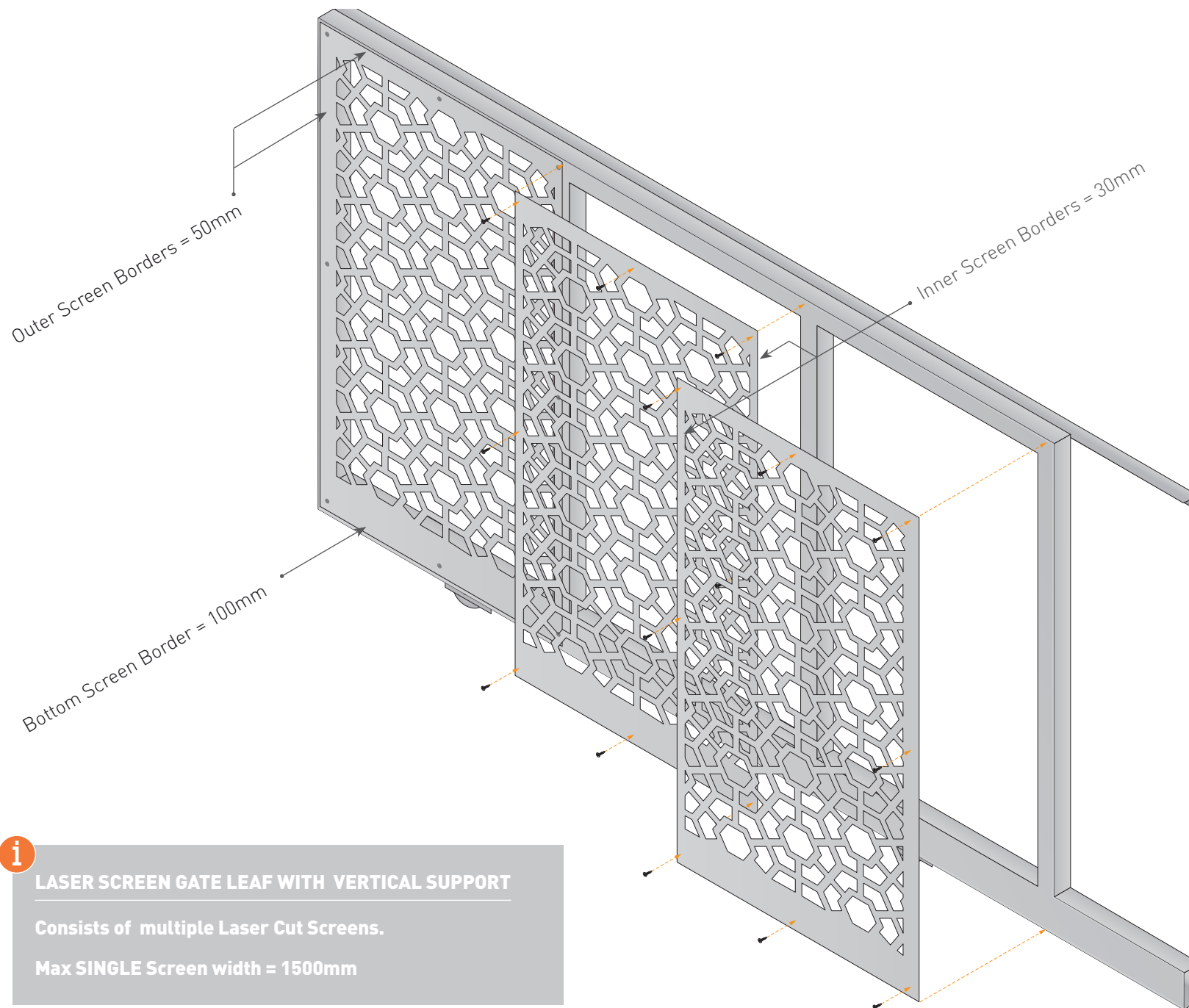

LASER SCREEN DIMENSIONS ARE SET 5MM SHORTER ON EACH EDGE THAN FRAME SIZE TO ACCOUNT FOR RADIUS EDGE



LASER SCREEN GATE LEAF WITH VERTICAL SUPPORT

Consists of multiple Laser Cut Screens.

Max SINGLE Screen width = 1500mm

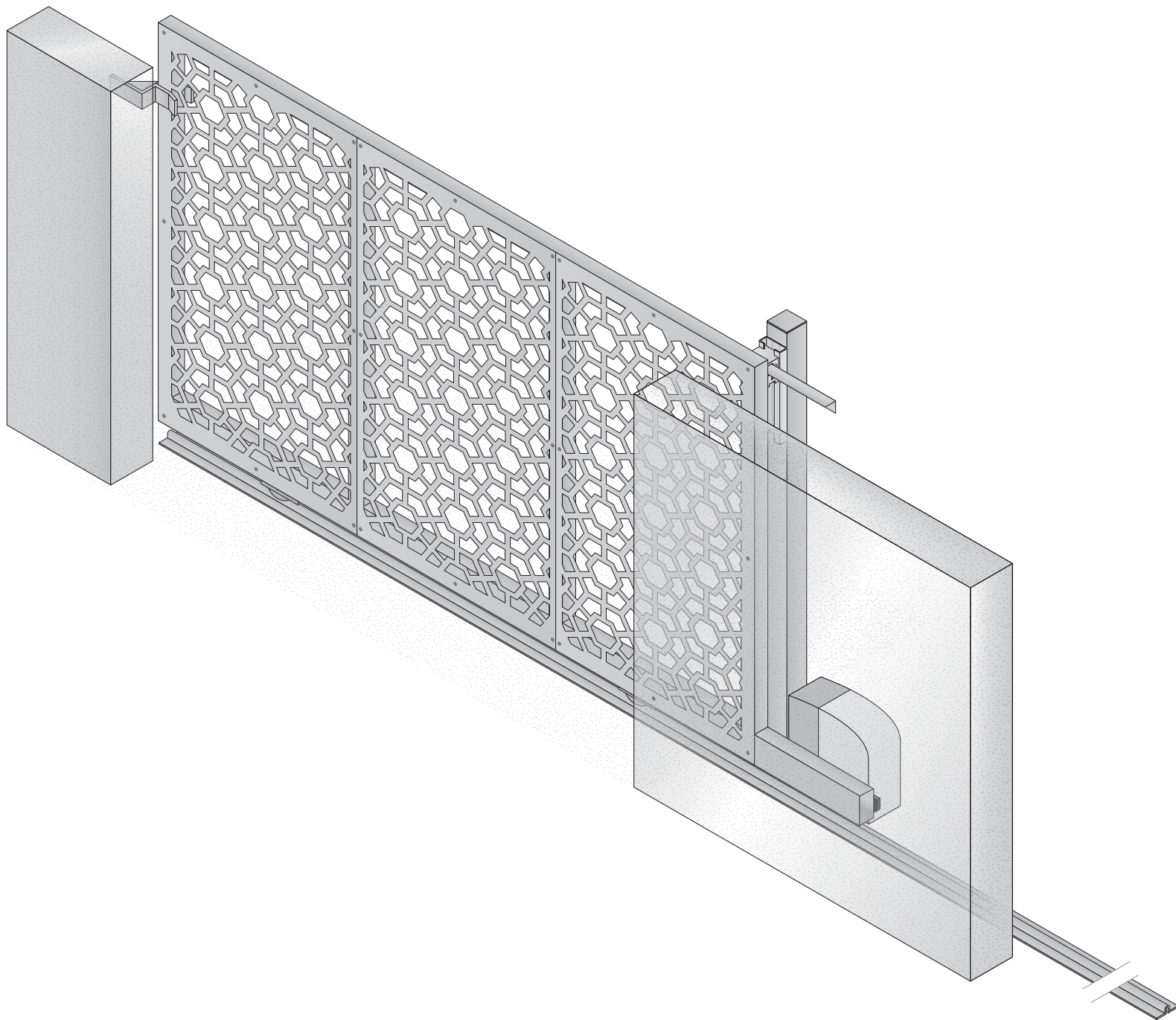

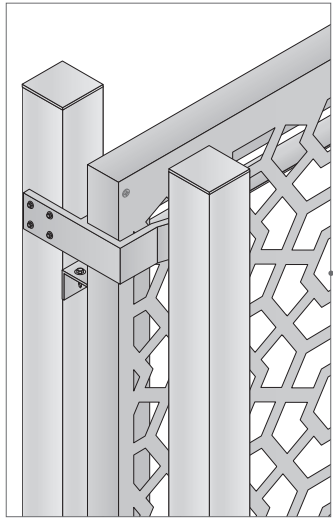

STANDARD F STOP ALTERNATIVE POV

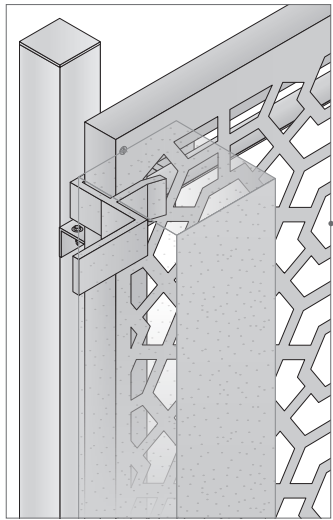

CUSTOM F STOP ALTERNATIVE POV

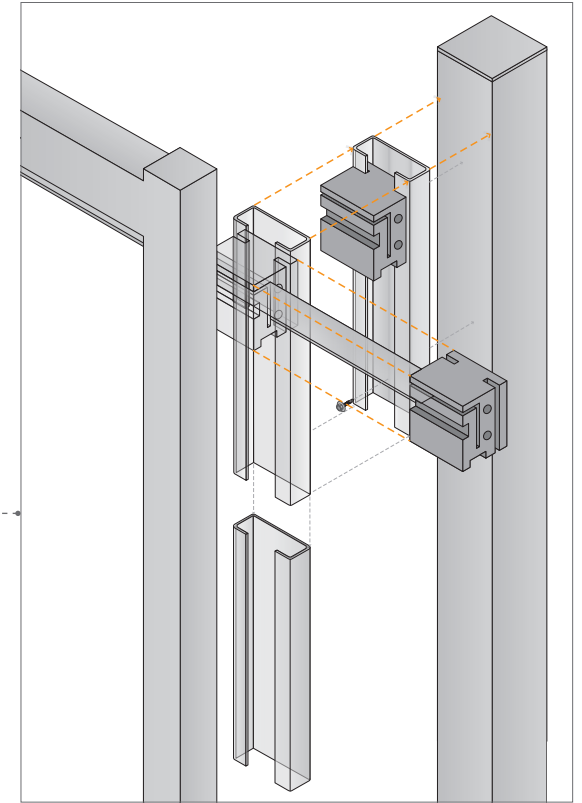
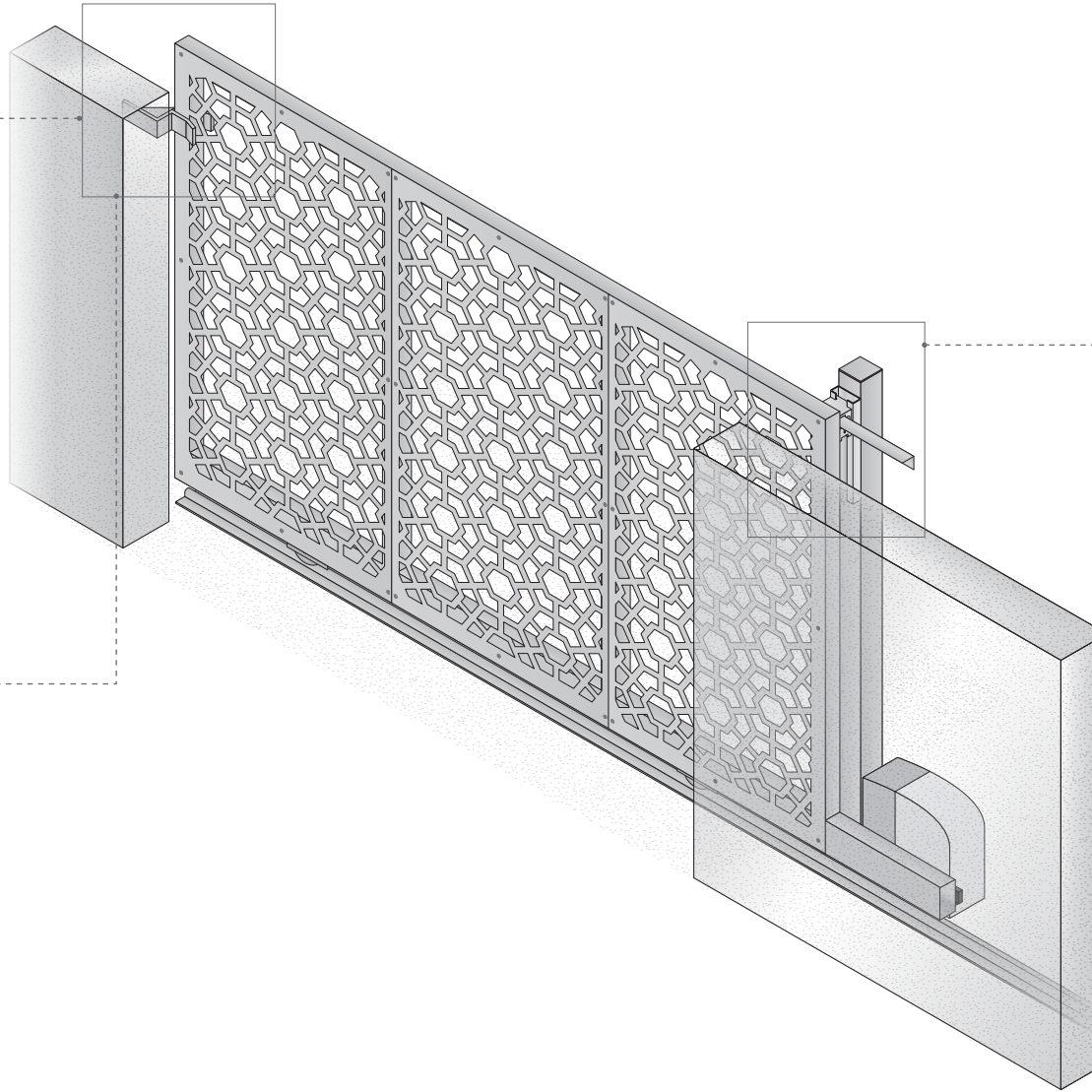

SLIDING GATE GUIDE POST DETAIL

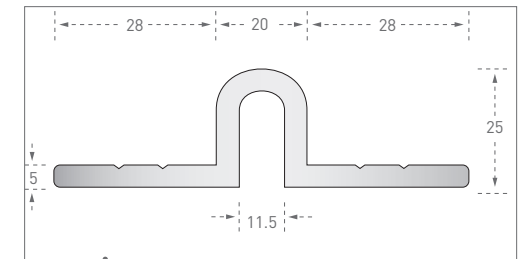

SLIDING GATE TRACK

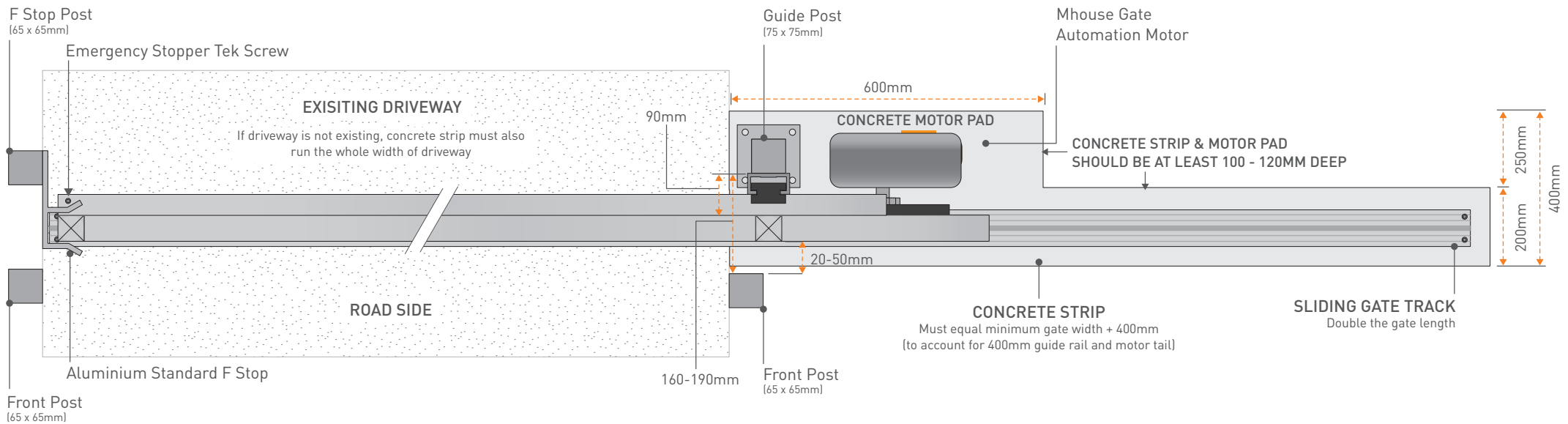

STANDARD F STOP OPTION

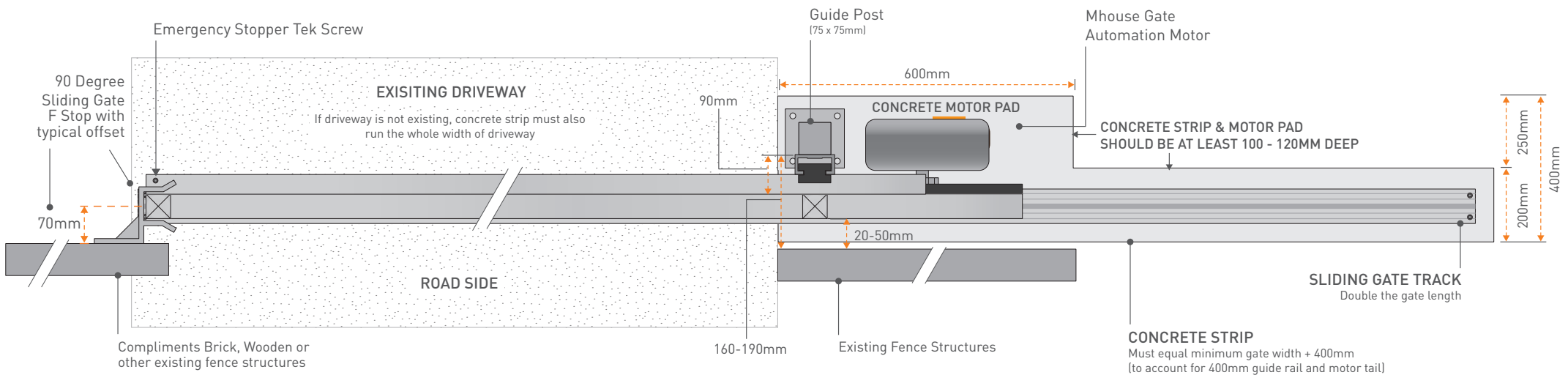

CUSTOM F STOP OPTION

MOTORIZED SLIDING GATE: (SINGLE LEAF SLIDING GATE)

Gate fabricates with high quality MS steel brand APL APOLLO

Gate outer frame made by 120x60x4mm MS rectangular tube.

Inside vertical sections of same section and MS sheet of 1.6mm with vertical pipe support

Vertical guide supports 100X100mm MS pipe of 4mm thickness

300mm height spike bar on gate top.

Bottom sliding track, fabricate by I-beam section 125x65mm and round bride bar 25mm

Gate size 10000mm and height 2400mm, wheels height 150mm include

Gate with overlap 12000mm and height 2400mm

approx. weight 2500kg

Complete gate with 2 coat red oxide primer.

Galvanized Wheel with double wall bearing and mounting bracket, 2nos.

Nylon guide with double ball bearing horizontal fixing plates.

Sliding gate operator electromechanical motor, made in Italy complete with control card, photo cell, push button and flashing light, galvanized rack with studs. Suitable for 2500kg gate weight

